



BLUE I
TECHNOLOGIES

Reagents Mixing Instructions

For HYDROGUARD® HG-702 / HYDROGUARD® HG-302

For DPD1 or DPD4

Blue I Water Technologies

www.blueitechnologies.com

Blue I Water Technologies Ltd., 18 Ha'melacha St., Rosh Ha'ayin 4809148, Israel
Tel: +972-9-7680004, Fax: +972-9-7652331, e-mail: info@blueitechnologies.com

The following procedure describes how to mix and install the reagent bottles.

1. Open the HYDROGUARD Chlorine Indicator and Buffer kit.

The following items should be in the box:

- ✓ Chlorine indicator and buffer mixing instructions.
 - ✓ 1 X 600 ml bottle of chlorine buffer with a white label.
 - ✓ 1 X 600 ml bottle of chlorine indicator fluid with a blue label.
 - ✓ 1 X small bottle of chlorine indicator salt with a white label.
2. Remove the caps on both the indicator fluid [1] and small indicator salt [2] bottles.
 3. Empty the contents of the indicator salt into the bottle of indicator fluid [3].
 4. Place the cap on the bottle of chlorine indicator fluid and close tightly [4].
 5. Turn the bottle upside-down slowly and carefully, so that no bubbles form in the fluid [5].
 6. Repeat five times until all the indicator salt is dissolved in the indicator fluid.

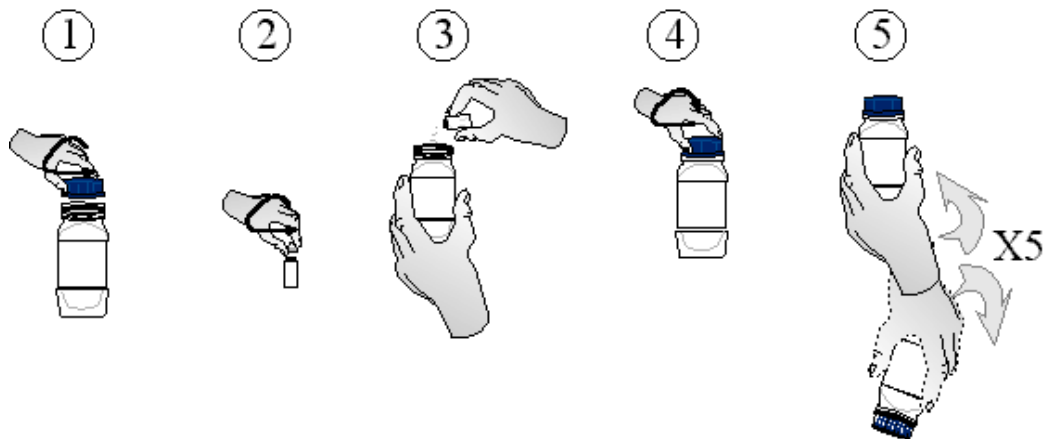

Mixing Indicator Salt into Indicator Fluid

Replacing reagent bottles

1. Remove the cap from the reagent bottles.
2. Place the opening of the reagent bottle below the bottle siphons.
3. Lift the bottle up until the opening reaches the bottle siphon cap.
4. Push the lever above the siphon cover away from you, and push the reagent bottle up.
5. Push the bottom of the bottle into position.

Caution: Do not refill the reagent bottles.
Do not mix or add reagent from other bottles.
Do not use any non-Blue I Technologies reagents.



Reagent Level Switch

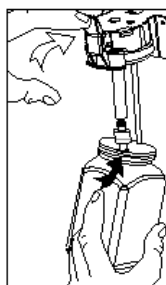

Reagent Bottles and Siphon Caps

Note: The Chlorine indicator, with the blue label, should connect to the blue siphon.

Prime the reagent pumps on the HYDROGUARD HG-702/HG-302

1. Press Menu on the control panel keypad until the Reagent Pump menu appears and Press OK
2. Enter password (123 is default) using the UP or DOWN Arrows
3. Press OK (OFF will appear on top line)
4. Press OK again (OFF will appear on top and bottom lines)
5. Press UP to turn the reagent pumps ON. (The reagent pumps will turn ON if water is flowing and the analyzer is not in a test mode. If it does not turn ON, wait for test to end and solenoid to open.)
6. Press DOWN to turn pumps OFF when water flowing from the colorimeter has a red tint or reagent drops are being formed at the needle tips.
7. Press Escape twice (2x) to return to the main screen

Note: The water will only have a visible red tint if it has a chlorine concentration above 0.2 PPM and below 10 PPM. If outside of this range, remove the colorimeter cap and confirm that reagents are being pumped.



BLUE I
TECHNOLOGIES

Blue I Water Technologies

Ver.1.4

www.blueitechnologies.com

Blue I Water Technologies Ltd., 18 Ha'melacha St., Rosh Ha'ayin 4809148, Israel
Tel: +972-9-7680004, Fax: +972-9-7652331, e-mail: info@blueitechnologies.com